



8:00



8:30



9:00



10:00



11:00



„General building supervisory approval“ with the approval number Z-23.34-1325 for multilayer installation of Styrodur® CS under the base slab. The approval permits single-layer, two-layer and three-layer arrangement of Styrodur® CS up to a total thickness of 300 mm for the use in constantly pressurized water.



Certificate BASF SE
Approval no.: Z-23.34-1325 for Styrodur® CS



Certificate „passive house suitable component“
Connection without thermal bridge
ISOLOHR passive house floor panel



PASSIV
HAUS
geeignete
Komponente
Dr. Wolfgang Feist

Only the original of IsoLohr® is made of



Europe's green insulation

ISOLOHR GmbH

Würzburger Straße 35
D-97737 Gemünden-Langenprozelten

Phone +49 (0) 93 51 - 60 44 95 -0
Fax +49 (0) 93 51 - 60 44 95 -26
eMail info@isolohr.de

Web www.isolohr.de

ISOLOHR®

The pre-finished floor panel formwork system

the pre-finished floor panel formwork system

the pre-finished floor panel formwork system

the pre-finished floor panel formwork system

the pre-finished floor panel formwork system

the pre-finished floor panel formwork system

the pre-finished floor panel formwork system

the pre-finished floor panel formwork system

the pre-finished floor panel formwork system

the pre-finished floor panel formwork system

the pre-finished floor panel formwork system

the pre-finished floor panel formwork system

the pre-finished floor panel formwork system

the pre-finished floor panel formwork system

the pre-finished floor panel formwork system

the pre-finished floor panel formwork system

the pre-finished floor panel formwork system

the pre-finished floor panel formwork system

the pre-finished floor panel formwork system

the pre-finished floor panel formwork system

the pre-finished floor panel formwork system

the pre-finished floor panel formwork system

the pre-finished floor panel formwork system

the pre-finished floor panel formwork system

the pre-finished floor panel formwork system

the pre-finished floor panel formwork system

the pre-finished floor panel formwork system

the pre-finished floor panel formwork system

the pre-finished floor panel formwork system

the pre-finished floor panel formwork system

the pre-finished floor panel formwork system

the pre-finished floor panel formwork system

the pre-finished floor panel formwork system

the pre-finished floor panel formwork system

the pre-finished floor panel formwork system

the pre-finished floor panel formwork system

the pre-finished floor panel formwork system

the pre-finished floor panel formwork system

the pre-finished floor panel formwork system

the pre-finished floor panel formwork system

the pre-finished floor panel formwork system

the pre-finished floor panel formwork system

the pre-finished floor panel formwork system

the pre-finished floor panel formwork system

the pre-finished floor panel formwork system

the pre-finished floor panel formwork system

the pre-finished floor panel formwork system

the pre-finished floor panel formwork system

the pre-finished floor panel formwork system

the pre-finished floor panel formwork system

the pre-finished floor panel formwork system



IsoLohr® floor panel system: Always the right choice

The IsoLohr® floor panel system is a formwork system to create thermally insulated base slabs. Whether the building is designed after EnEV standard or as passive house:

The IsoLohr® floor panel system is always the right choice.

Characteristics of the system:

- Individually designed and manufactured for the building
- Short construction times without cut-offs and assembling work on site
- Significant reduction of set-up and measurement efforts
- Insulation is also formwork, completely without support, no additional formwork resources required
- Construction of the original Styrodur® C
- General building supervisory approval for multilayer installation up to 300 mm
- General building supervisory approval for the use in pressurized water
- Planning reliability during the execution
- Free from CFCs, HCFCs and HFCs
- Passive house certified system
- Horizontal ground insulation according to EN ISO 13793 against frost heave of the building, foundation to frost depth penetration not applicable (optional)
- Basement lining of 10 mm Duripanel, ready-to-use surface (optional)
- Increased value of the building
- Can be built-up without previous knowledge

Specifications

Floor insulation

Rated value of compressive stress according to Z-23.34-1325

- 185 kPa
- 255 kPa
- 355 kPa

Compressive stress according to DIN EN 826

- 300 kPa
- 500 kPa
- 700 kPa

Lateral insulation

Embossed surface for plaster adhesion



Thermal conductivity

Insulant thickness / λ :

- 60 mm / 0,035 W/(mK)
- 100 mm / 0,038 W/(mK)
- 120 mm / 0,039 W/(mK)



Thermal transfer coefficient

Insulant thickness / k-value:

- 60 mm / 0,54 W/(m²K)
- 100 mm / 0,36 W/(m²K)
- 120 mm / 0,31 W/(m²K)
- 160 mm / 0,22 W/(m²K)
- 200 mm / 0,18 W/(m²K)
- 240 mm / 0,16 W/(m²K)
- 300 mm / 0,12 W/(m²K)

The given k-values include the transfer resistance with adjacent air on the inside and ground contact on the outside.

$$R_i = 0,13 \text{ m}^2\text{K/W}; R_e = 0,0 \text{ m}^2\text{K/W}$$

Base plate (optional)

- Mineral-bound flat-pressed panel, customized color design
DIN 1052: 2004-08, Tab. F.19
- Material thickness: 10 mm
- Panel height: up to 600 mm
- Connected permanently and frictionally to side insulation

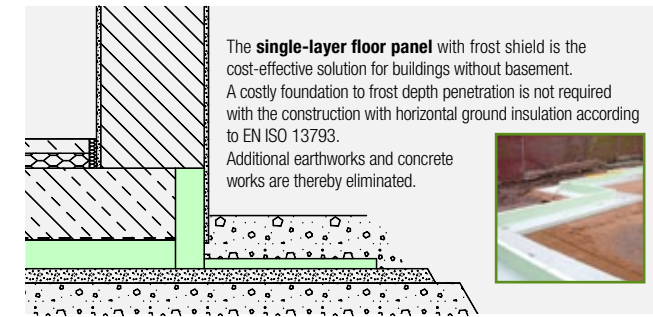

The **single-layer floor panel** with frost shield is the cost-effective solution for buildings without basement. A costly foundation to frost depth penetration is not required with the construction with horizontal ground insulation according to EN ISO 13793. Additional earthworks and concrete works are thereby eliminated.

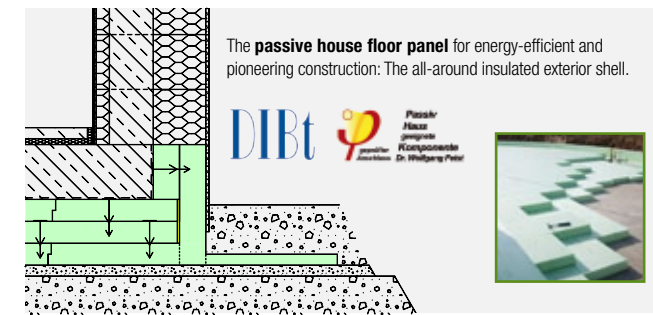

The **passive house floor panel** for energy-efficient and pioneering construction: The all-around insulated exterior shell.

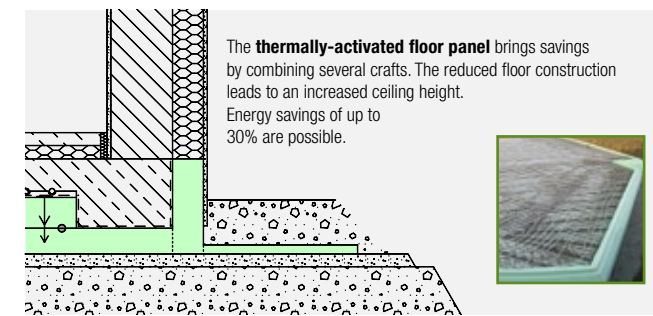

The **thermally-activated floor panel** brings savings by combining several crafts. The reduced floor construction leads to an increased ceiling height. Energy savings of up to 30% are possible.

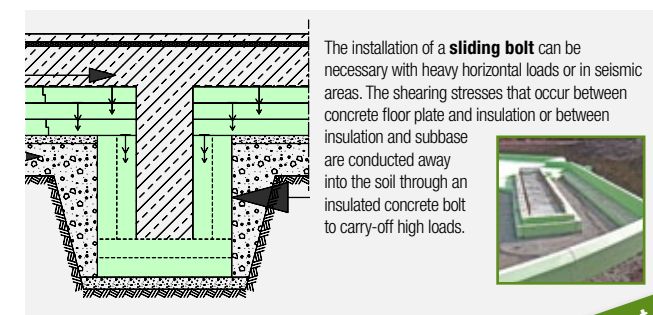

The installation of a **sliding bolt** can be necessary with heavy horizontal loads or in seismic areas. The shearing stresses that occur between concrete floor plate and insulation or between insulation and subbase are conducted away into the soil through an insulated concrete bolt to carry-off high loads.